

JILONG
Since 1993

KL-520

FTTx Fusion Splicer



8S
Splicing



18S
Heating



0.01dB
Average loss

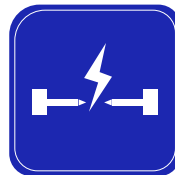

5000
Electrode life



Real time discharge
processing



4 Motors
aligning

Description

- Fast-splicing 8S Fast-heating 18s
- 5000 Times electrode life
- Average loss under 0.01dB
- 5200mAh Battery capacity. Splicing & Heating 300 times
- 320X Fiber image magnification, the fiber core is clearly visible
- 3.5" TFT color LCD
- 10000 Groups of fusion records/ 2000 groups images
- Real time discharge processing, stable Fiber splicing
- FTTx Fiber optic fusion splicer. Easy to operate
- USB interface; Convenient for data download and software update

Feature

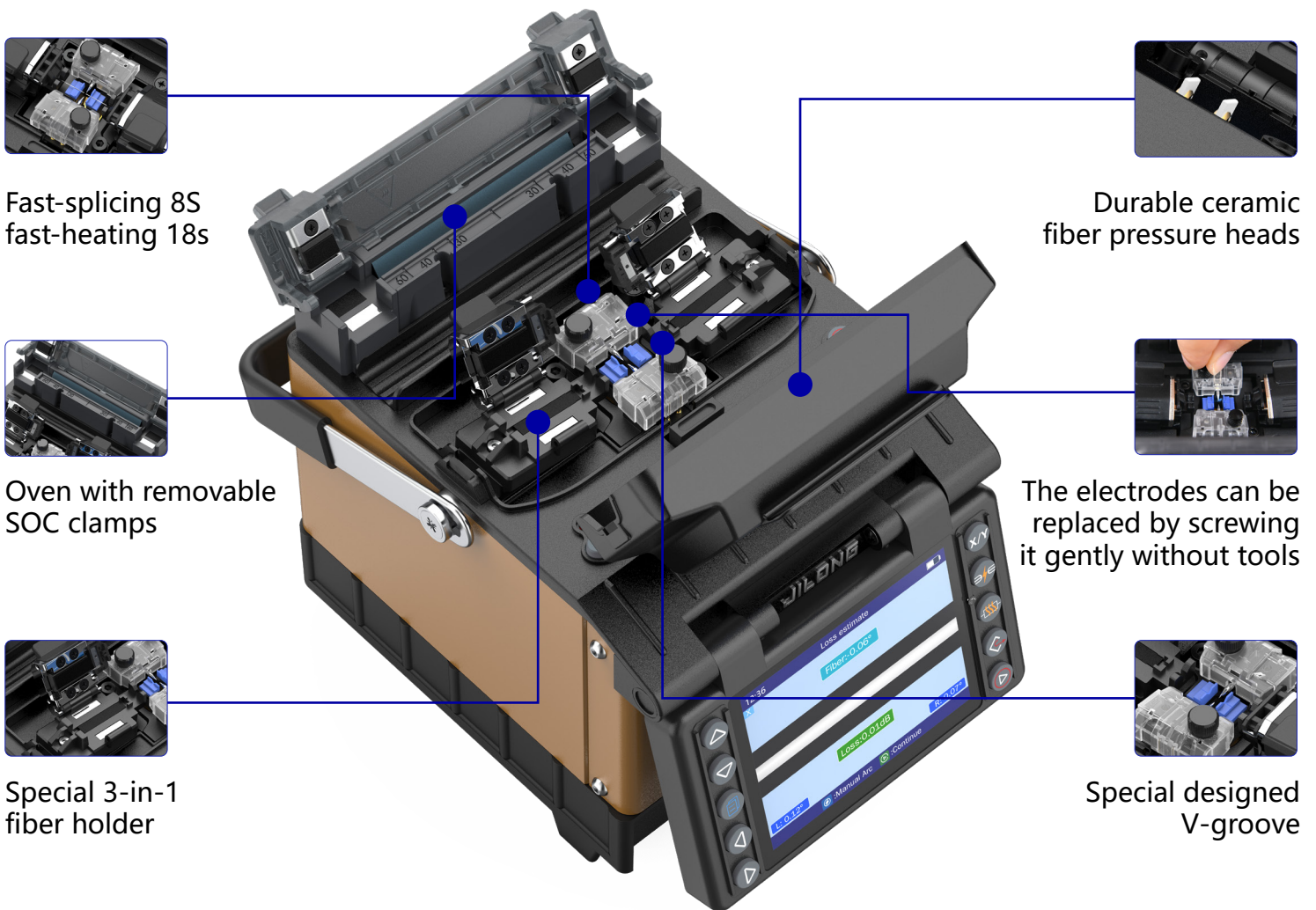

3-in-1 Universal Fiber Holder

Suitable for bare fiber; 3.0mm jump fiber; pigtail fiber; FTTH fiber

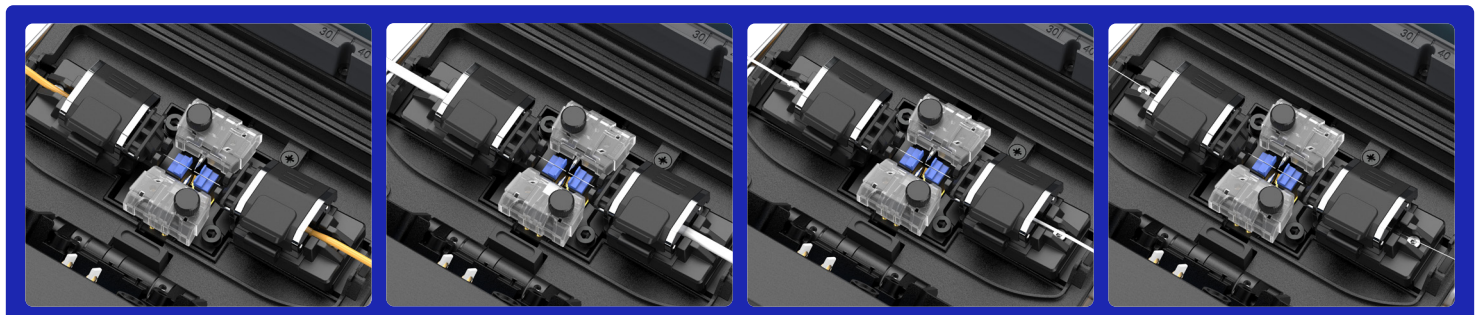

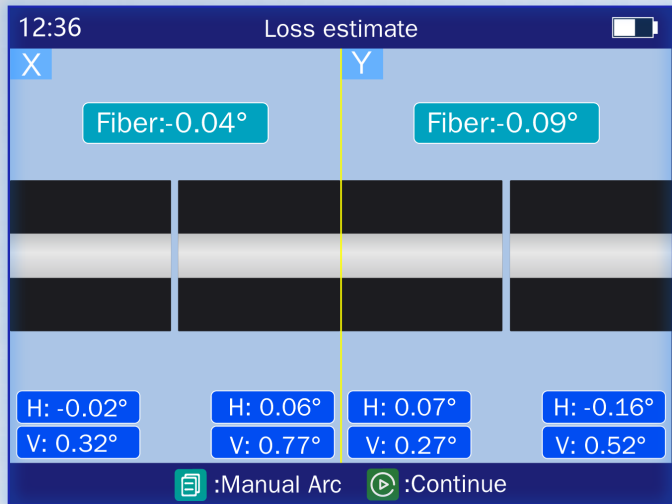

8S
Fast-splicing



18S
Fast-heating



FTTx fusion splicer
easy to operate



300 Times splice &
heat cycles



5200mAh
Battery capacity

Installation completion effect



Rich expansibility fiber optic cleaver operating platform (Optional)

Support the placement of cleaver operating platform, do cleaving and splicing work in one step (Operation platform be ordered separately)

Invention patent application number 202210544729.X
Utility model patent application number 202221202906.8

Installation instructions of fiber optic operating platform

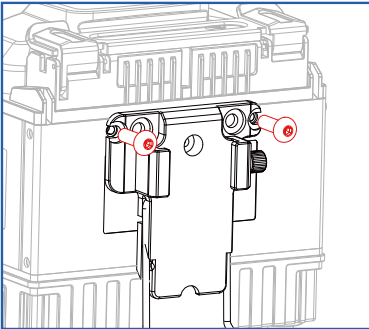

Step 1:
Install the fixing plate behind the fusion splicer with screws (M3/ M4/ M5).

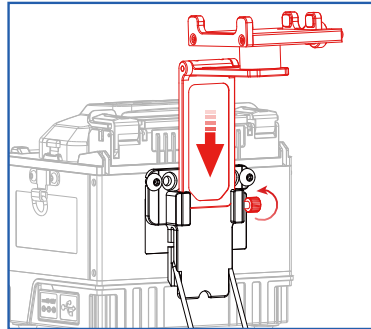

Step 2:
Insert the support plate into the fixing plate and tighten the fixing screws.

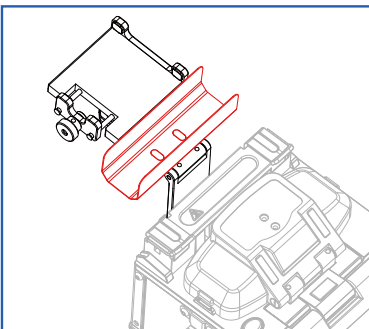

Step 3 :
Place the cooling tray in the corresponding position of the support plate, and the installation is completed.

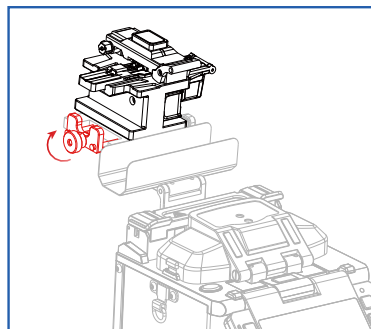

Step 4 :
After placing the fiber cleaver on the operating platform, adjust the depth of the screw so that the rubber pad fits the cleaver completely.

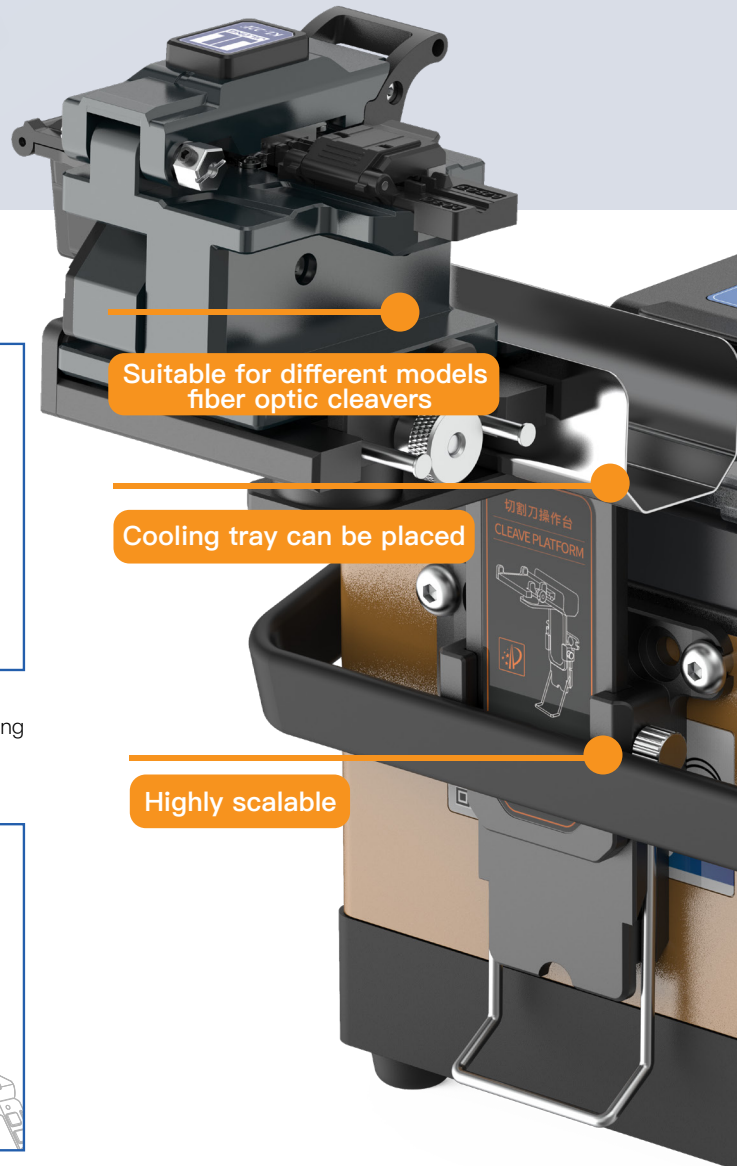

Suitable for different models fiber optic cleavers

Cooling tray can be placed

Highly scalable

*Operation platform be ordered separately



Specification

Splice Method	Active Clad-Alignment
Applicable Fibers	SM(ITU-T G.652&G.657) / MM(ITU-T G.651) / DS(ITU-T G.653) / NZDS(ITU-T G.655)
Compatible Fiber/Cable	0.25~3.0 mm / indoor cable
Fiber Holder	Replaceable (Universal: FH-60, SOC Holder: FH-SOC(optional))
Fiber Diameter	Cladding: 80~150μm, Coating: 100~1000μm
Fiber Cleave Length	8~16 mm
Splice mode	Max 128 modes
Typical Splice Loss	SM: 0.03dB / MM: 0.01dB / DS: 0.04dB / NZDS: 0.04dB / G.657: 0.03dB ★①
Return Loss	>>60dB
Splicing Time	SM Quick mode : 8 sec / SM Average: 10 Sec.
Estimated Splice Loss	Available
Heating Time	Quick mode 18 sec.(SM G652 250μm 40mm Sleeve) adjustable
Protection Sleeve Length	20mm, 30mm, 40mm, 50mm, 60mm
Heat Programs	Max 32 modes
Battery	5200mAh Battery Capacity, Typical 300 Cycles (Splice&Heat) per Charge ★②
Electrode Life	5000 arcs, can be extended by using an electrode grinder ★③
Auto-start	Splice / Heating
Automatic Fiber Identification	/
Automatic ARC Identification	Automatic arc calibration by air pressure and temperature
Results Storage	The last 10,000 splice records and 2,000 result images
Tension Test	1.96~2.25N
Operating Condition	Altitude: 0~5000m, 0~95% relative humidity, -20~50°C, Max Wind 15m/s
Storage Condition	0~95% relative humidity, -20~60°C
Display	3.5" color high resolution (800 x 480) display
Fiber Magnification	X, Y, XY, X/Y : 320X Magnification
Power Supply	AC Input 100~240V, DC Input 9~14V
Terminal	USB2.0
Weight	1.59kg without battery / 1.92kg with battery
Size	155H x 138W x 145D mm (including rubber bumper)

★① With identical fibres(in room temperature). Measured by cut-back method relevant to ITU-T and IEC standards.

★② Splice & Heat cycles may vary depending on the battery status and the operating environment.

★③ Electrode life may vary depending on the operating environment.



Product Display



Packing Size

- ① Carrying case
- ② Power charger
- ③ Cutter storage box
- ④ KL-520 Fusion splicer
- ⑤ Alcohol bottle
- ⑥ FPS-60 Splicing protector sleeves
- ⑦ FOCW Cleaning wipes(box)
- ⑧ Lithium battery
- ⑨ KL-22F Fiber optic cleaver
- ⑩ FTS-01 Drop cable stripper
- ⑪ FIS-FT11301T 3-hole fiber stripper



Contact us

HEAD OFFICE: Nanjing Jilong Optical Communication Co., Lt

Add: Room 401-402, Building 14-1, Xingzhahui Business Garden, No.19 Xinghuo Road, Pukou District Nanjing, Jiangsu, 210032, China

Web: www.JILONGOT.com

Mail: info@jilongot.com

TEL: +86 25 58880885



Focus on official website for more